

Neoprene Inserts

Blind threaded fastener that has a brass threaded insert molded into a neoprene bushing. Made of synthetic rubber and resistant to most chemicals, oils, and weather conditions. You can install this insert into through holes or blind holes without tools of any kind. This fastener makes the joint waterproof, isolates vibration and is electrically insulated.

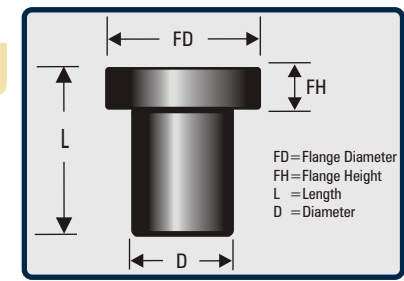

| UNIFIED THREAD SIZES (inch) | | Min-Max Grip | Hole Size (+.000 / -.006) | D. Nom (+.000 / -.006) | FD. Nom (+/- .006) | L. Nom (+/- .006) | FH. Nom (+/- .006) |
|-----------------------------|-------------|--------------|------------------------------|---------------------------|-----------------------|----------------------|-----------------------|
| Thread Size | Part Number | | | | | | |
| 6-32 | FPC632 | 0.375-0.607 | .250 | .240 | .554 | .981 | .035 |
| 6-32 | FPCE632 | 0.015-0.156 | .312 | .312 | .452 | .499 | .062 |
| 8-32 | FPCB832 | 0.015-0.156 | .312 | .312 | .438 | .499 | .052 |
| 8-32 | FPCC832 | 0.015-0.172 | .312 | .312 | .750 | .560 | .060 |
| 8-32 | FPC2D832 | 0.015-0.050 | .312 | .310 | .500 | .430 | .050 |
| 10-24 | FPCL1024 | 0.030-0.227 | .375 | .375 | .562 | .767 | .187 |
| 10-32 | FPC10S | 0.015-0.192 | .375 | .375 | .500 | .554 | .036 |
| 10-32 | FPC10SL | 0.312-0.643 | .375 | .375 | .562 | 1.051 | .051 |
| 10-32 | FPC10XL | 0.812-1.143 | .375 | .375 | .562 | 1.551 | .051 |
| 10-32 | FPCG1032 | 0.030-0.227 | .375 | .375 | .750 | .807 | .187 |
| 10-32 | FPCH1032 | 0.312-0.450 | .375 | .375 | .554 | .847 | .035 |
| 10-32 | FPCJ1032 | 0.030-0.227 | .375 | .375 | .750 | .700 | .080 |
| 10-32 | FPCQ1032 | 0.035-0.232 | .375 | .375 | .562 | .665 | .040 |
| 1/4-20 | FPC1/4S | 0.015-0.111 | .500 | .500 | .630 | .630 | .051 |
| 1/4-20 | FPCD1420 | 0.031-0.187 | .500 | .500 | .750 | .829 | .187 |
| 1/4-20 | FPCJ1420 | 0.250-0.457 | .500 | .500 | .635 | 1.051 | .051 |
| 5/16-18 | FPCE51618 | 0.015-0.156 | .625 | .620 | .875 | .725 | .125 |
| 5/16-18 | FPCF51618 | 0.156-0.375 | .625 | .620 | .875 | 1.100 | .225 |
| 3/8-16 | FPCA3816 | 0.015-0.437 | .750 | .750 | 1.250 | 1.062 | .187 |